



Cyclone

SERIES

Job _____ Item # _____

ELECTRIC CONVECTION OVENS

- Model CO11-E1 Single
- Model CO11-E2 Double

STANDARD FEATURES

- Energy efficient 10.5 KW oven direct forced air heat system
- 208v or 220v-240v, 60hz or 50hz, 1Ø or 3Ø
- Electronic temperature control
- Double-pane thermal glass door windows
- Oven lights
- 60-Minute timer with continuous ring alarm & manual shut-off
- 150°F (65°C) to 550°F (285°C) temperature range
- 1/4 HP air-cooled two-speed hi-lo fan motor
- Cool down fan mode
- Elements-on and temperature-ready indicator lights
- Porcelain enamel oven interior
- 11-Position removable rack guide with 1 5/8" spacing
- 5 Heavy-duty, positive-stop, chrome-plated wire racks
- Stainless steel front, top & sides
- 7-Gauge steel legs with durable Baker Tone finish
- Stainless steel, 55/45 split synchronized doors, with single left mounted handle
- Stainless steel door seals
- Front mounted, hinged control panel for easy service access
- 1/8" Welded angle iron frame construction
- Heavy-duty industrial grade insulation in top, sides, back & doors
- 2-year parts & labor warranty and 5-year warranty on doors

OPTIONS & ACCESSORIES

- Steam/moisture injection with front panel controls
- Computerized programmable controls with LED display for integrated use of Cook & Hold, fan speed, pulse fan mode, and manual override functions
- Open rack stand with rack supports
- 30" Stainless steel legs with undershelf
- Additional oven racks
- Heavy-duty caster set, two with caster locks
- Perforated rear panel
- Solid doors - N/C
- Correctional Facility package
- International voltages, 480V
- Stainless steel interior

CERTIFICATIONS



**Model CO11-E1
with optional casters**

SPECIFICATIONS

Full-size electric, forced air, single and double deck convection type oven. Standard specifications include 10.5 KW per deck and a patented two speed wheel-within-a-wheel enhanced air flow system powered by an energy saving 1/4 HP air cooled fan motor.

Door interlock switch automatically turns the fan and heating elements off when the oven door is open. A manual rotary switch will turn the fan on when the door is open for quick cool-down. The 60-minute timer has a continuous ring alarm with manual shut-off. An indicator light glows when the heating elements are on.

The oven interior measures 29" wide (737mm) by 20" high (508mm) by 22 1/2" deep (572mm). The cooking chamber is porcelain enamel over heavy gauge steel with removable 11-position rack guides with 1 5/8" spacing (41mm) and 5 heavy-duty adjustable chrome-plated racks.

The oven exterior measures 39 3/8" wide (1003mm) by 38 1/2" deep (978mm) by 33 5/16" high (846mm). Front, top and sides and trim are constructed with stainless steel. Single oven legs are 30" tall (762mm) (6" [152mm] for double), 7-gauge steel and finished with durable Baker Tone finish.

Dual doors are 55/45 split-type with double-pane thermal glass, synchronized operation, stainless steel seals and a single left mounted "Cool Touch" handle. Doors are fabricated with stainless steel inside-and-out, and fully insulated with 2" of industrial grade insulation.



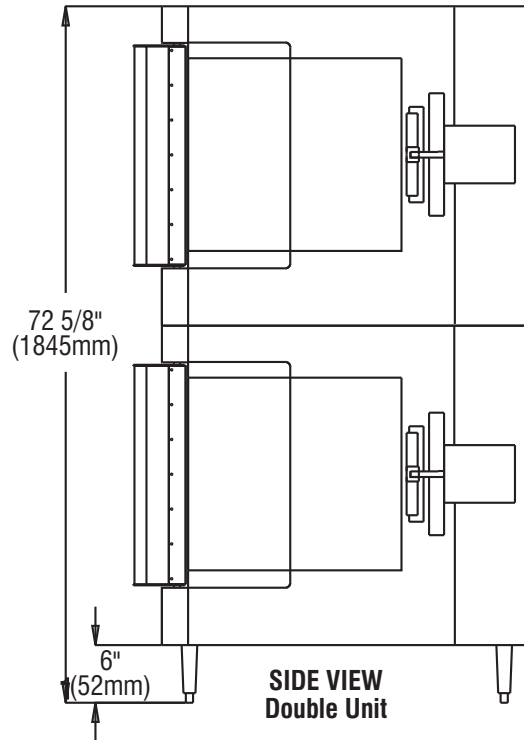
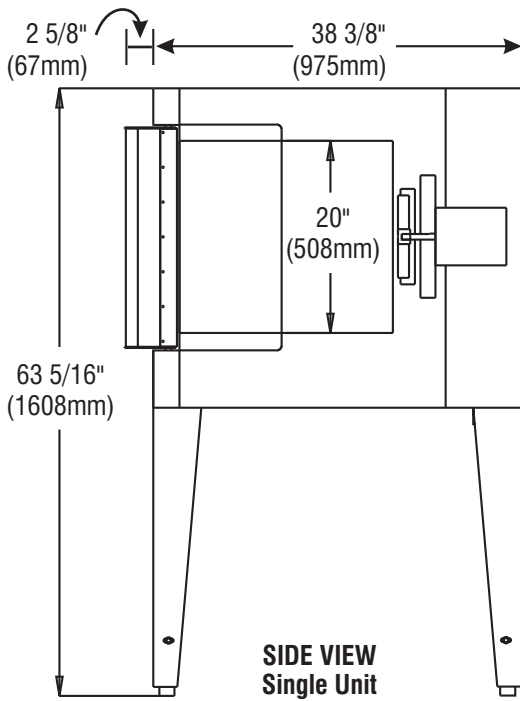
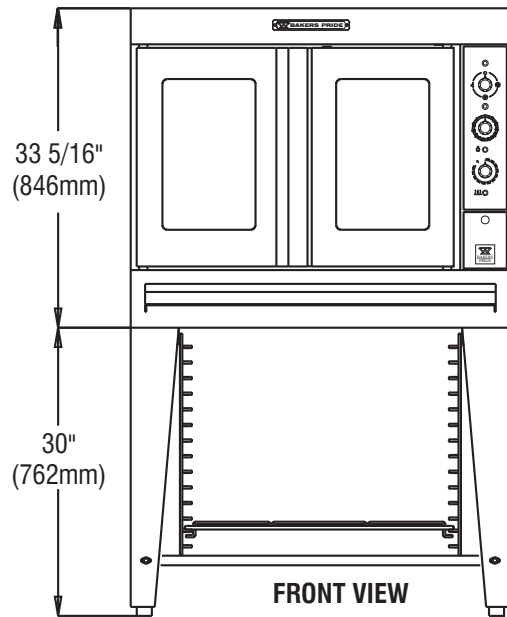
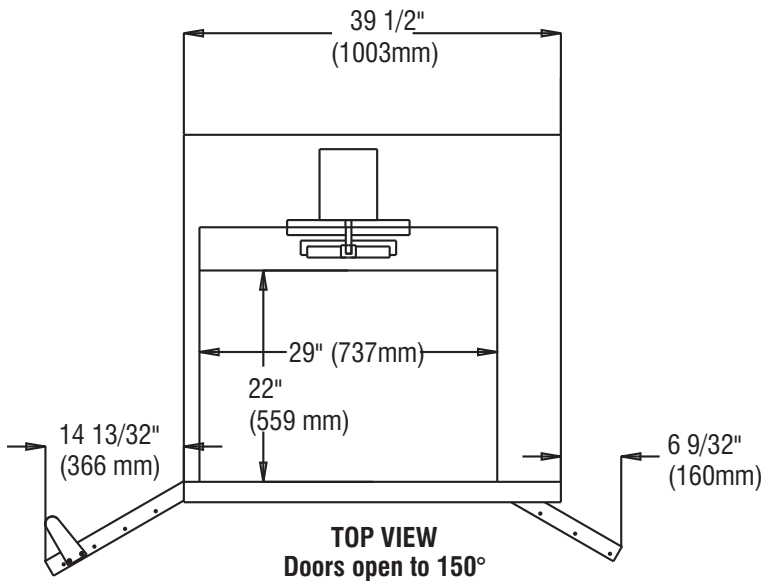

ALL DIMENSIONS NOMINAL

SHIPPING INFORMATION

| Model | Shipping Weight | | Carton Size | | Carton Dimensions | | | | | |
|---------|-----------------|-------|-------------|--------------|-------------------|------|--------|------|--------|------|
| | Lbs. | Kilos | Cubic Feet | Cubic Meters | Width | | Depth | | Height | |
| | Inches | mm | Inches | mm | Inches | mm | Inches | mm | Inches | mm |
| CO11-E1 | 640 | 291 | 47.8 | 1.26 | 45 | 1143 | 44 1/2 | 1130 | 41 3/4 | 1048 |

CO11-E2 Double *Shipped in two cartons as per above specifications*

POWER SUPPLY

| Model | KW | Voltage | Phase | Amps | | | Fan — 50 HZ | | Fan — 60 HZ | |
|-------|------|---------|-------|---------|--------|--------|-------------|----------|-------------|----------|
| | | | | Line 1 | Line 2 | Line 3 | RPM-low | RPM-high | RPM-low | RPM-high |
| | | | | CO11-E1 | 10.5 | 208 | 3 | 31.8 | 31.8 | 27.8 |
| | 10.5 | 220-240 | 3 | 30.2 | 30.2 | 26.2 | 825 | 1425 | 1140 | 1,725 |
| | 10.5 | 208 | 1 | 52 | 52 | — | 825 | 1425 | 1140 | 1,725 |
| | 10.5 | 220-240 | 1 | 49.5 | 49.5 | — | 825 | 1425 | 1140 | 1,725 |

Each oven requires separate electrical connections

MINIMUM CLEARANCES

| | Vent Hood | | Direct Venting | |
|-------|-----------|----|----------------|----|
| | Inches | mm | Inches | mm |
| Right | 1 | 25 | NA | NA |
| Left | 1 | 25 | NA | NA |
| Rear | 3 | 76 | NA | NA |

Suitable for installation on combustible floors when installed on factory supplied legs or casters

