



Item #: \_\_\_\_\_  
Model: CPO-ED-12H  
Product Name: Electric Counter Top Pizza Oven  
w/2 Hearths



*Model CPO-ED-12H*

#### Specification:

Garland Model Number CPO-ED-12H, electric counter top pizza oven. Compact 25-1/2"W x 26-3/4"D size includes a two decks with hearths. Stainless steel exterior. 650°F, (343° C) adjustable electromechanical thermostat and mechanical 15-minute timer. 208 or 240 volt, single phase, (please specify).

Ideal for pre-baked and fresh dough pizza.

#### Standard Features:

- Incoloy tubular heating elements, (total 3.6 kW)
- 650°F, (343°C), adjustable, electro-mechanical thermostats, one per oven cavity
- One fifteen minute mechanical timer per oven cavity
- 3" crown heights
- Oven ready light indicates oven has reached selected temperature, one per oven cavity
- 1½" thick insulation in walls, top, and doors
- 2 removable baking hearths
- All stainless steel finish
- Standard with 6-ft. (1.8m) long cord and plug (single-phase models only)
- 208 or 240 volts, single phase (please specify)
- One-year parts and labor warranty

#### Optional Features:

- ☐ 4" adjustable legs
- ☐ 60-minute timer

#### Capacity:

- Two (2) 20" pre-baked crust or fresh dough pizzas, (not designed for pan pizza)



**Pizzaovens.com**

1.877.FOR.OVEN  
367.6836

**Since 1999**

**GARLAND®**

Item #: \_\_\_\_\_

Model: CPO-ED-12H

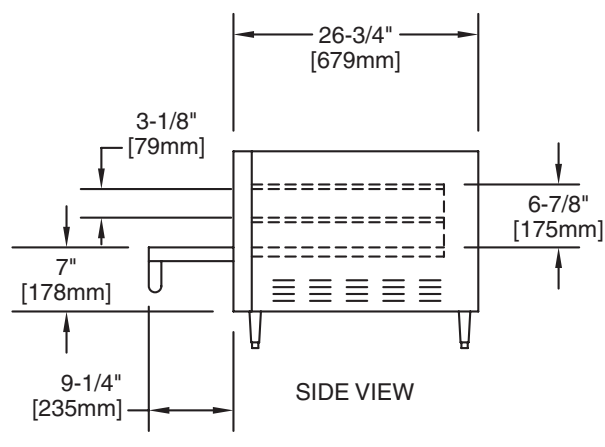
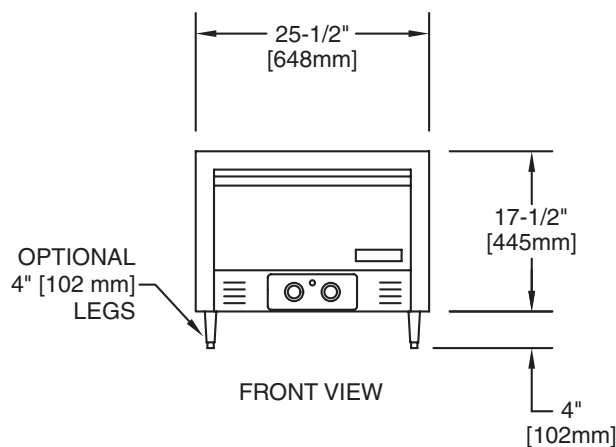
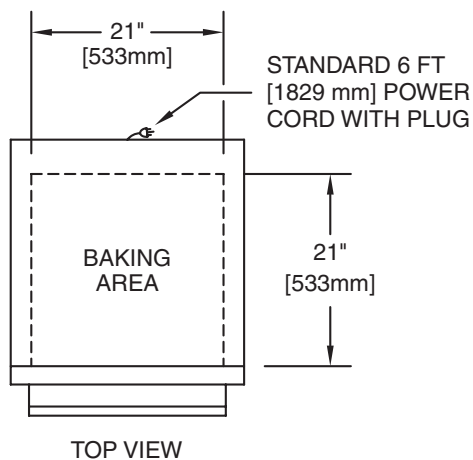
Product Name: Electric Counter Top Pizza Oven  
w/2 Hearths

### Electrical Specifications

Voltage	Phase	kW	Nominal Amperes	NEMA Plug	Connection Type
208	1	3.6	34.6	6-20P	6' Line Cord
240	1	3.6	32.6	6-20P	6' Line Cord

Clearances			
Installation		Entry	
Sides	Rear	Crated	Uncrated
1" (25mm)	1" (25mm)	32" (813mm)	27-1/2" (699mm)

[Pizzaovens.com](http://Pizzaovens.com)
1.877.FOR.OVEN  
367.6836

Since 1999

Continuous product improvement is a Garland policy, therefore design and specifications are subject to change without notice.

Printed in USA

Form # CPOED12H R2 (08/06)